

Drawer Plansifter

AMDP

Function:

- Employing maximum sifting area for screening grinded materials according to grain varieties.

Main Features:

- Having a very high efficiency in comparison with the similar kinds.
- Strong supporting structure with enclosure panels and flap doors in light alloy material.
- Square sieves are clamped separate from the protecting flap doors which only function as a covering.
- Perfect sealing of the square sieves leaves no surplus in the plansifters.
- Silent regular operation and long life expectancy.
- Maximum exploitation of the sifting surface using special cleaning system which leaves no blind angles.
- Removable square sieves can be drawn out and checked and changed from any position independently which is considered as a distinctive feature of Ard Machine Drawer Plansifter AMDP.
- Ease and rapidity in accessing the inner parts of the machine.
- Practicality and ease of maintenance of this type of plansifters has always been approved by the owners.
- Central movement system with controlled spherical roller bearing and spherical thrust bearing which are lubricated with oil, using CNC boring machines, the place of the bearings are machined simultaneously.

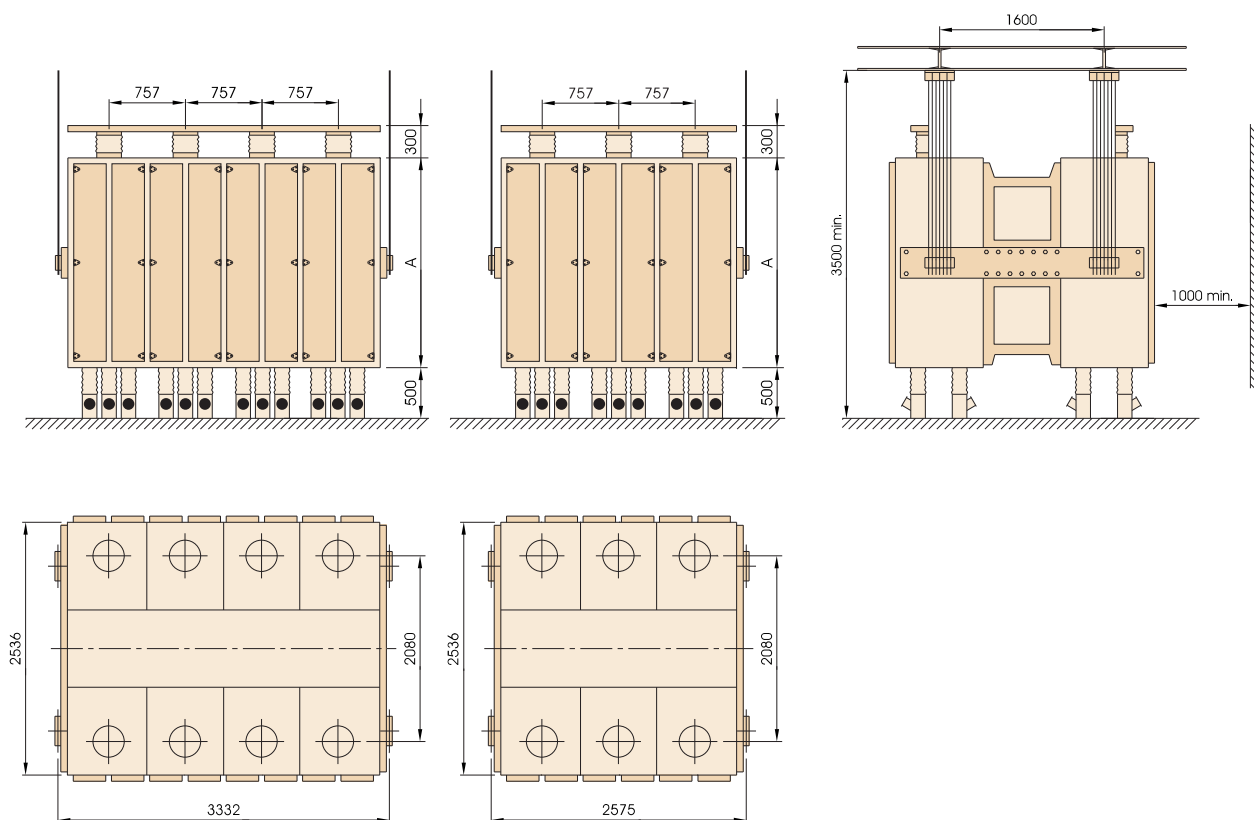

Ard Machine Drawer Plansifter

Type	No. of sections	No. of sieves per section	Gross surface [m ²]	Motor (50 Hz) [kW]	A [mm]	Net weight [kg]	Shipping volume [m ³]
AMDP 6/22	6	22	40.3	4	2068	3660	18.8
AMDP 8/22	8		53.6	5.5		4650	24.9

- The electric motor also operates utilizing power supply of 60 Hz.

ARD MACHINE
manufacturing company

Head office: Vali-e-Asr Ave. No.1050/6 - Seventh Floor
No.702 - Post Code: 14338 - Tehran - Iran
Tel.: +98 21 88713695 & 7 Fax: +98 21 88713685

Factory: Qazvin Industrial Zone
Tel.: +98 282 222 30 29
Fax: +98 282 222 30 19

E-mail: info@ardmachine.com
Web Site: www.ardmachine.com